

TRANSFORMATOR

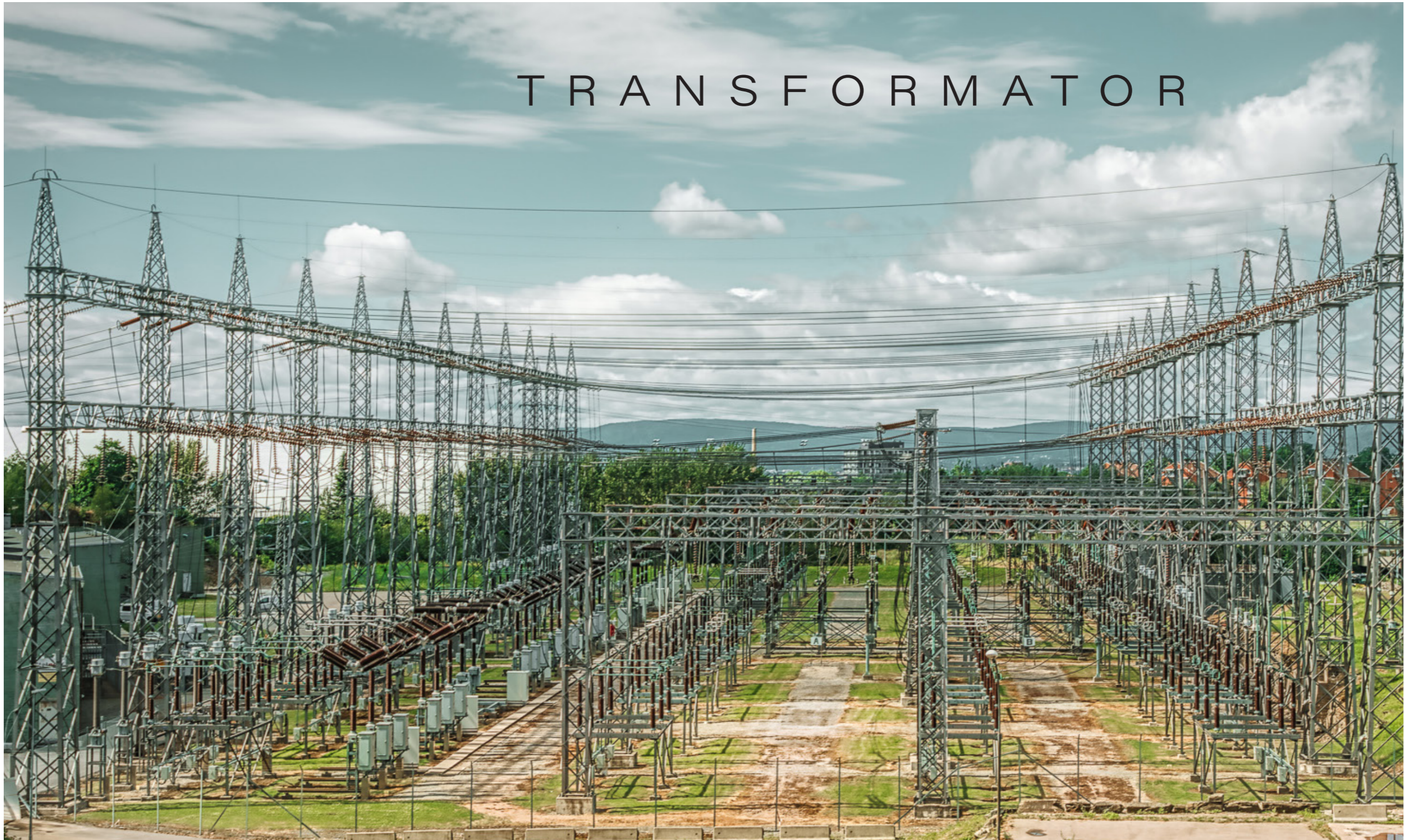

Karine Støvne Berg • Ståle Sandvik Holm • Karine Grønstad Solberg • Lene Hauge

KONTEKST



STRATEGI

-ANVENDE MASTENE SOM TYDELIGE IDENTITETSMARKØER PÅ ULVEN.

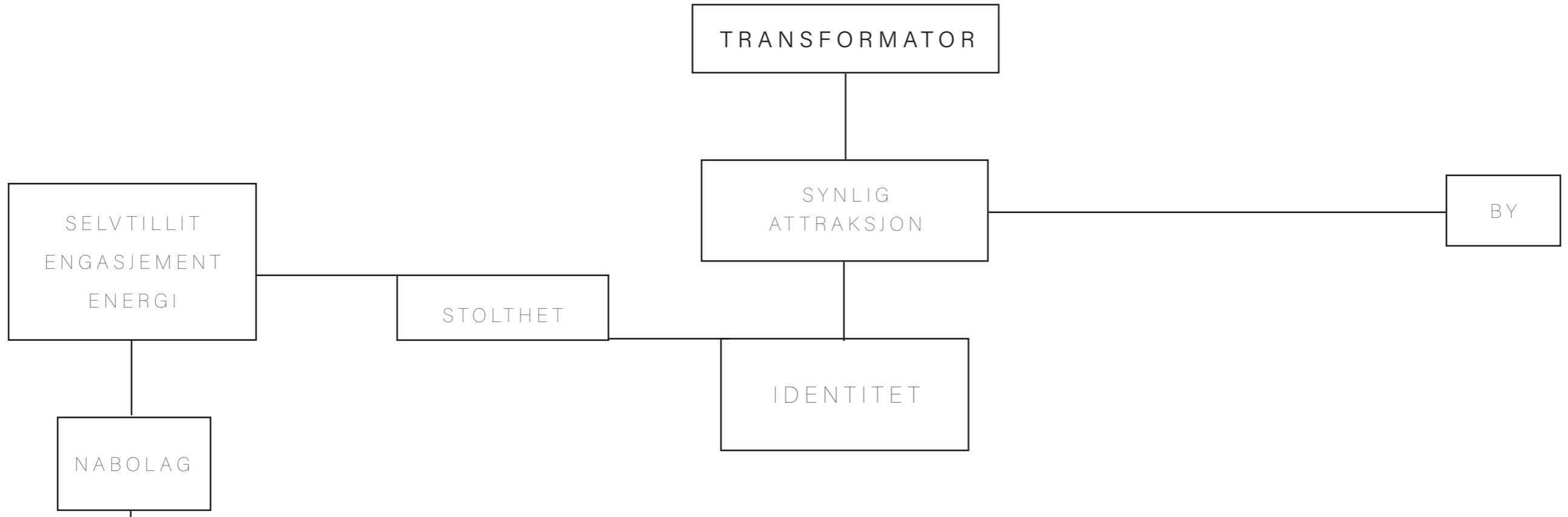

ANALYSER

Sikt



Strømnett



tettboddhet

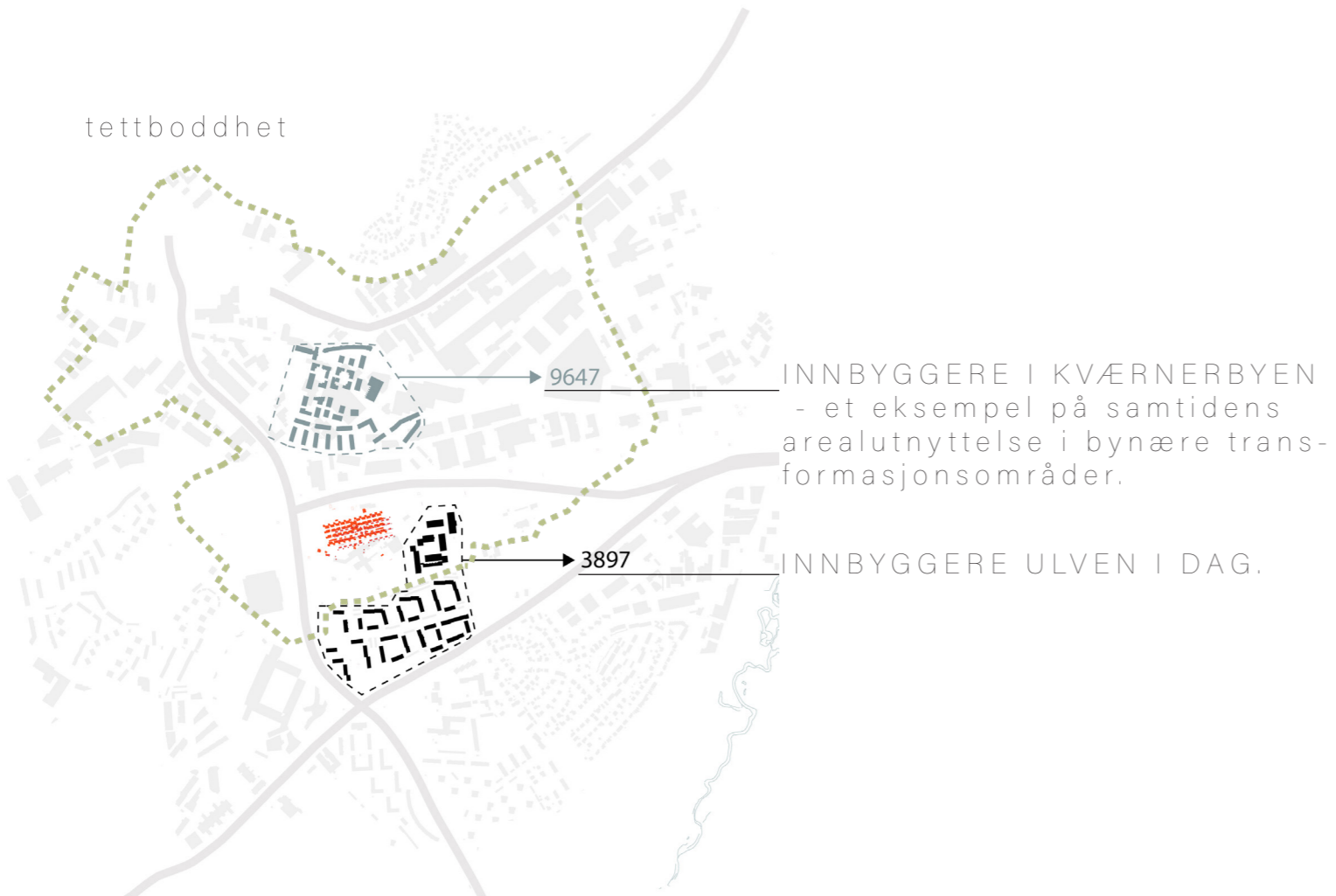

INNBYGGERE I KVÆRNERBYEN
- et eksempel på samtidens
arealutnyttelse i bynære trans-
formasjonsområder.

INNBYGGERE ULVEN I DAG.

Barrierer



PRINSIPPER - STYRKE OVERGANGER OG GRØNN MOBILITET

Eksisterende overganger



fremtidige overganger



Eksisterende gåmønster



Fremtidige gåmønster



PRINSIPPER - ABSORBERE OG TRANSFORMERE STØY

FRA TRAFIKKSTØY

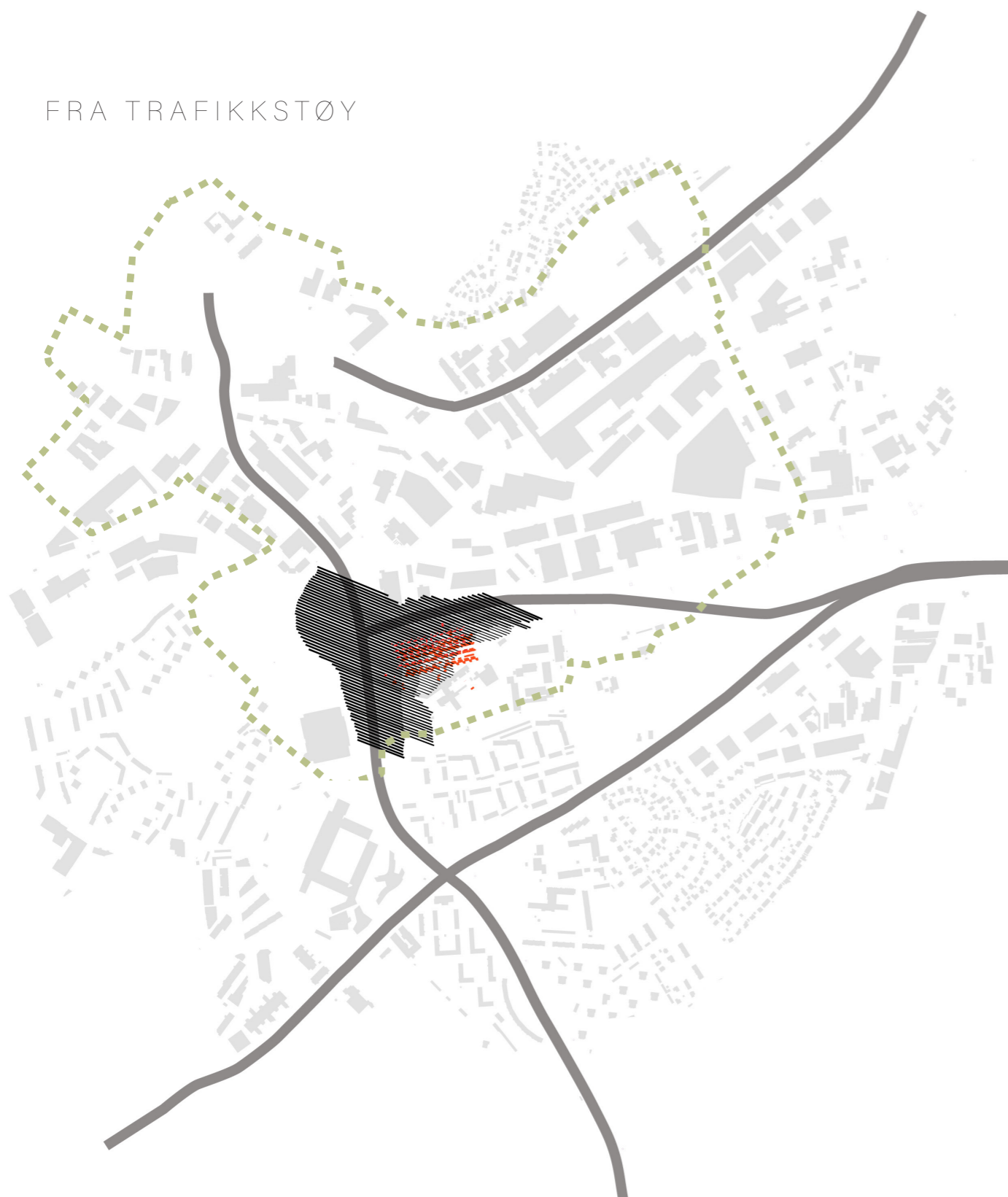

TIL KULTURBRÅK

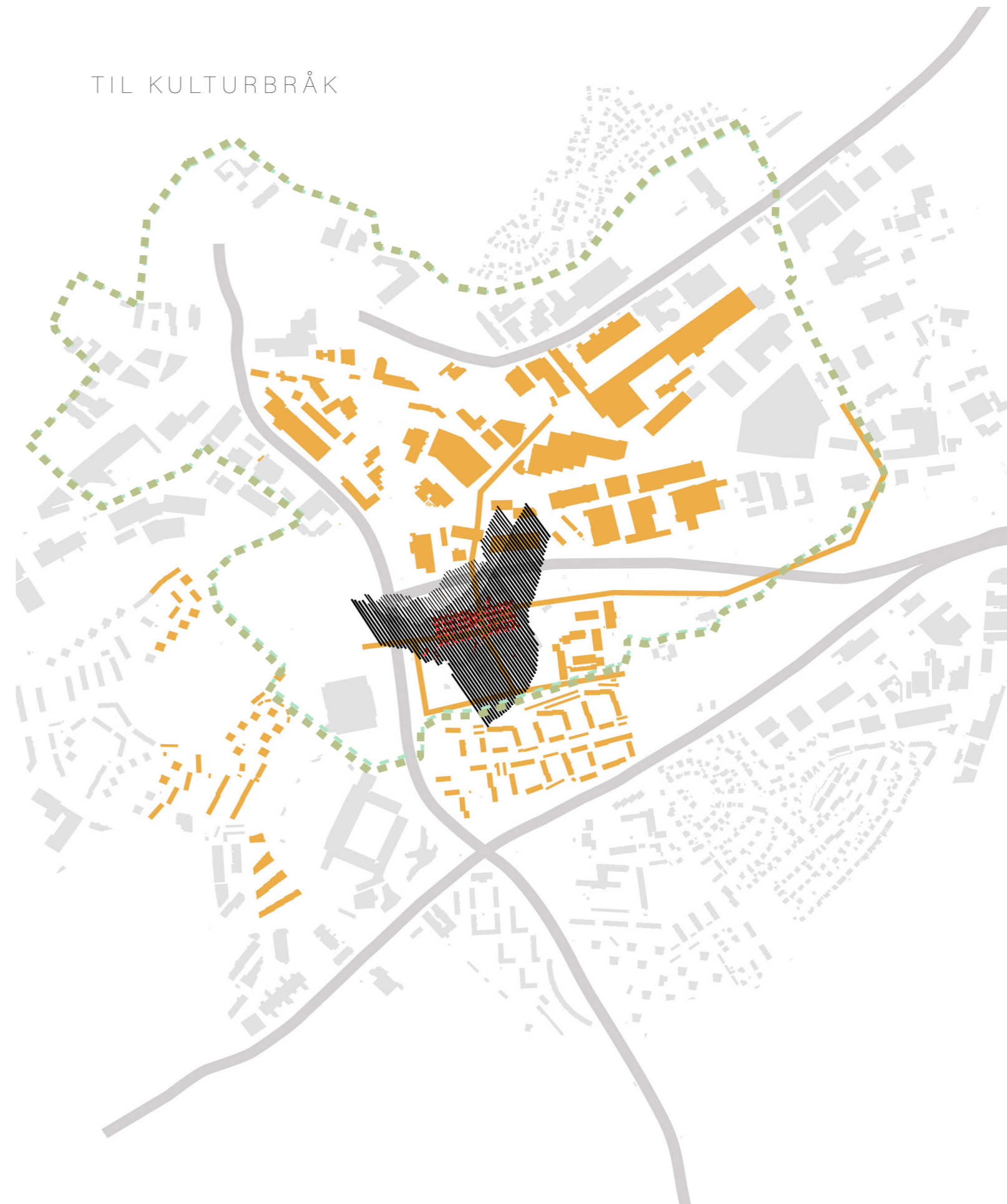

EKSISTERENDE STØY

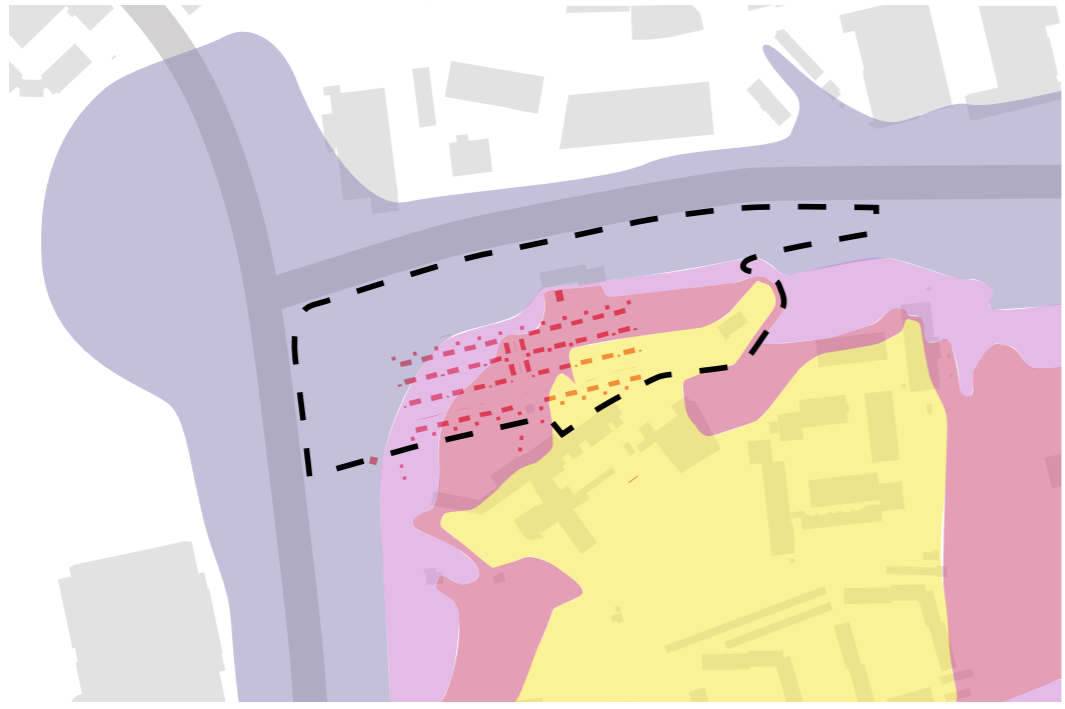

FREMTIDIG STØY

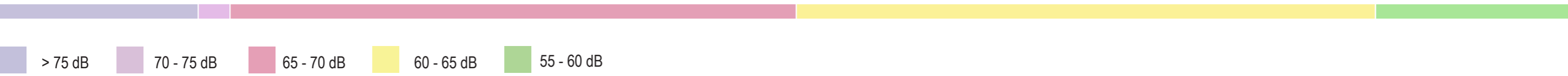
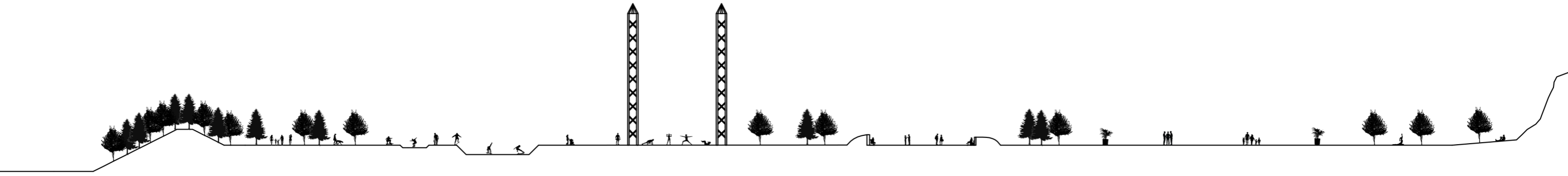

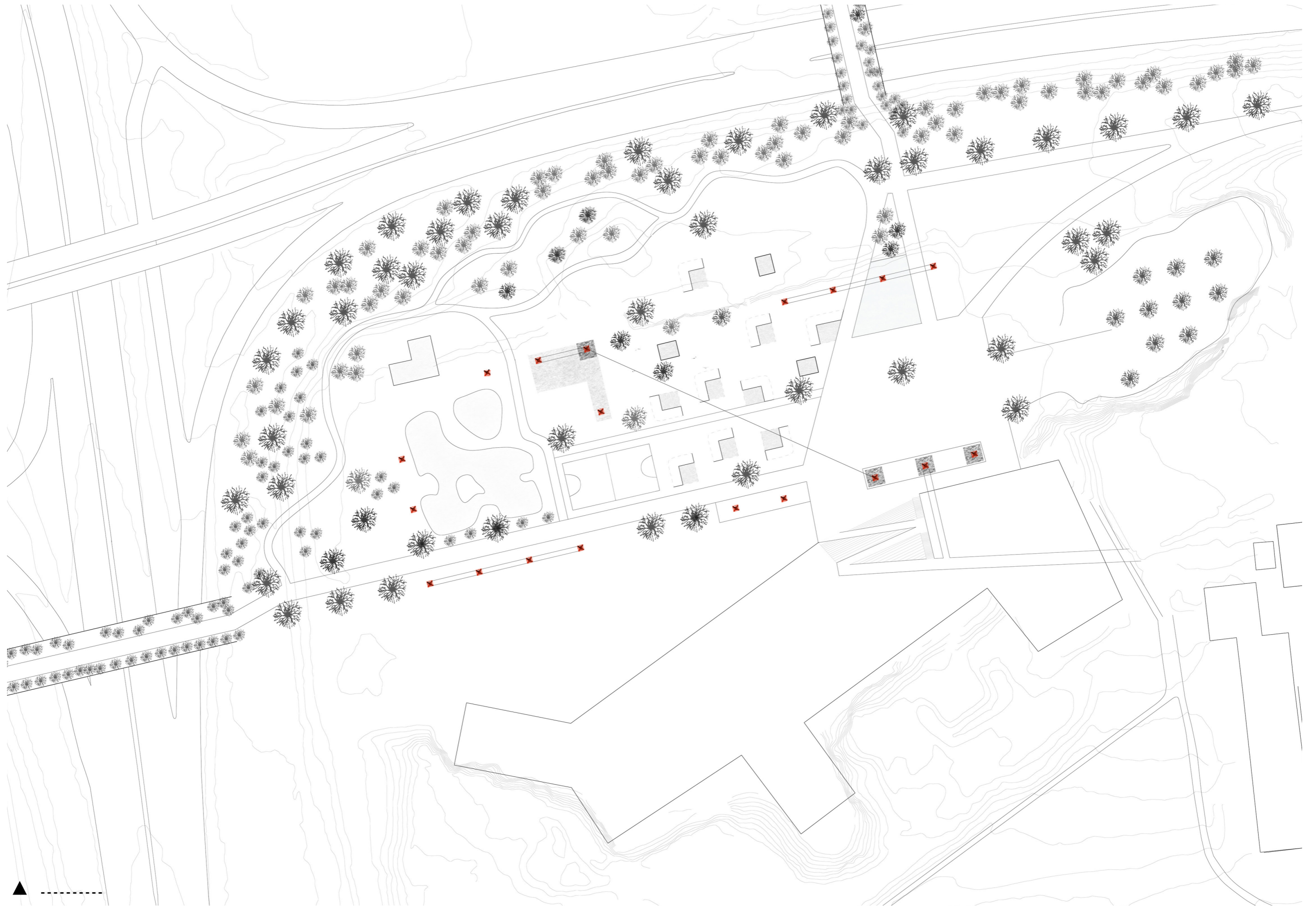

FUNKSJONER OG BRUKERE - FRA NABOLAG TIL BY

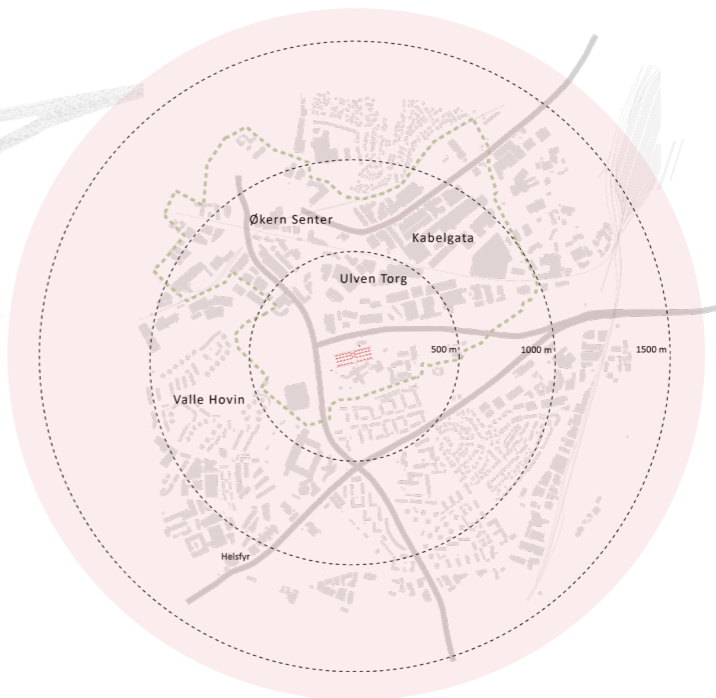
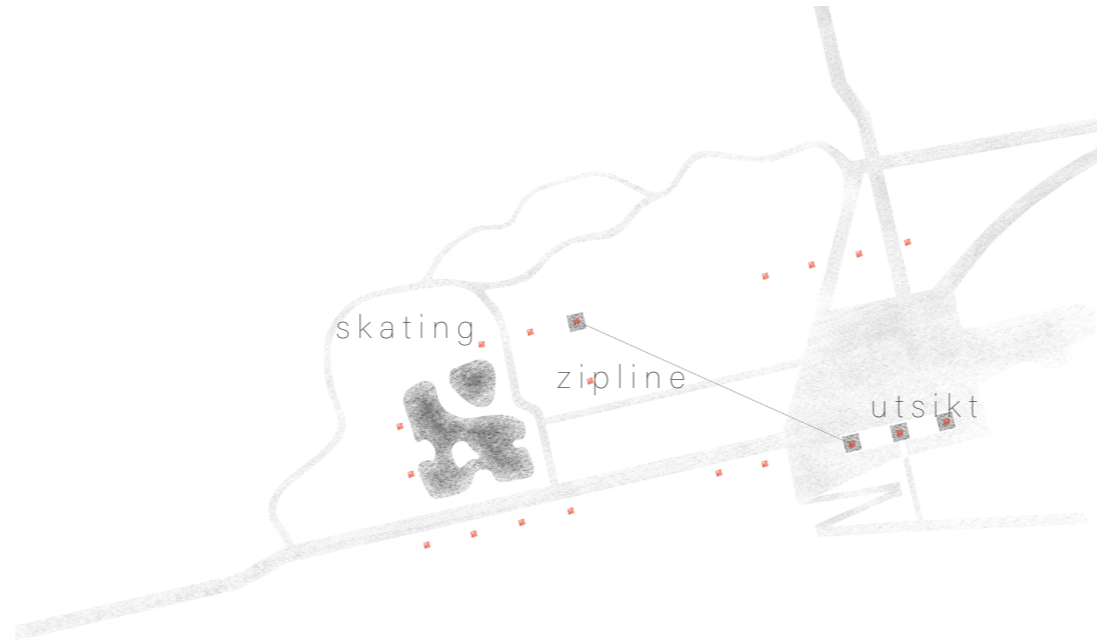
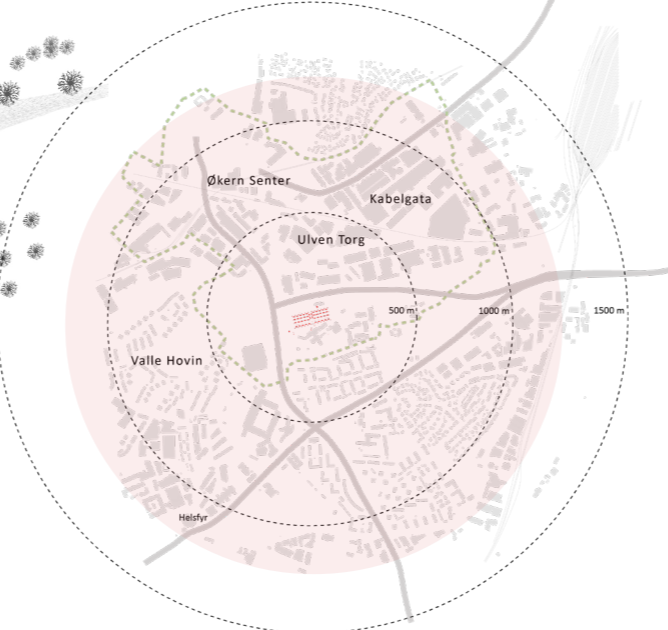
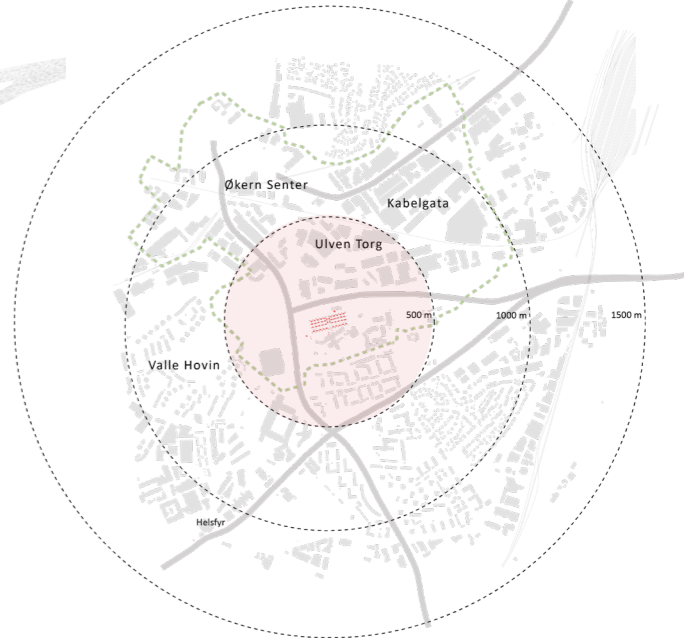
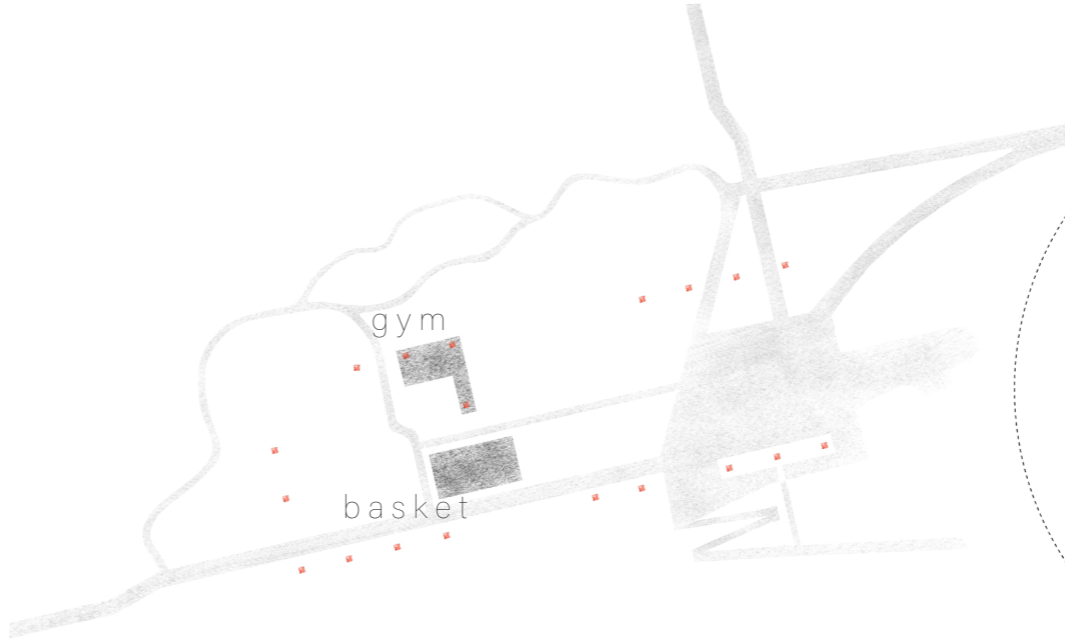

STØYVOLLER OG TURTERRENG



Tegnforklaring

- Nye koter
- - - Ekst. koter
- ◻ ▽ Ramper

N
M 1 : 100 / A3

STØYVOLLER OG TURTERRENG

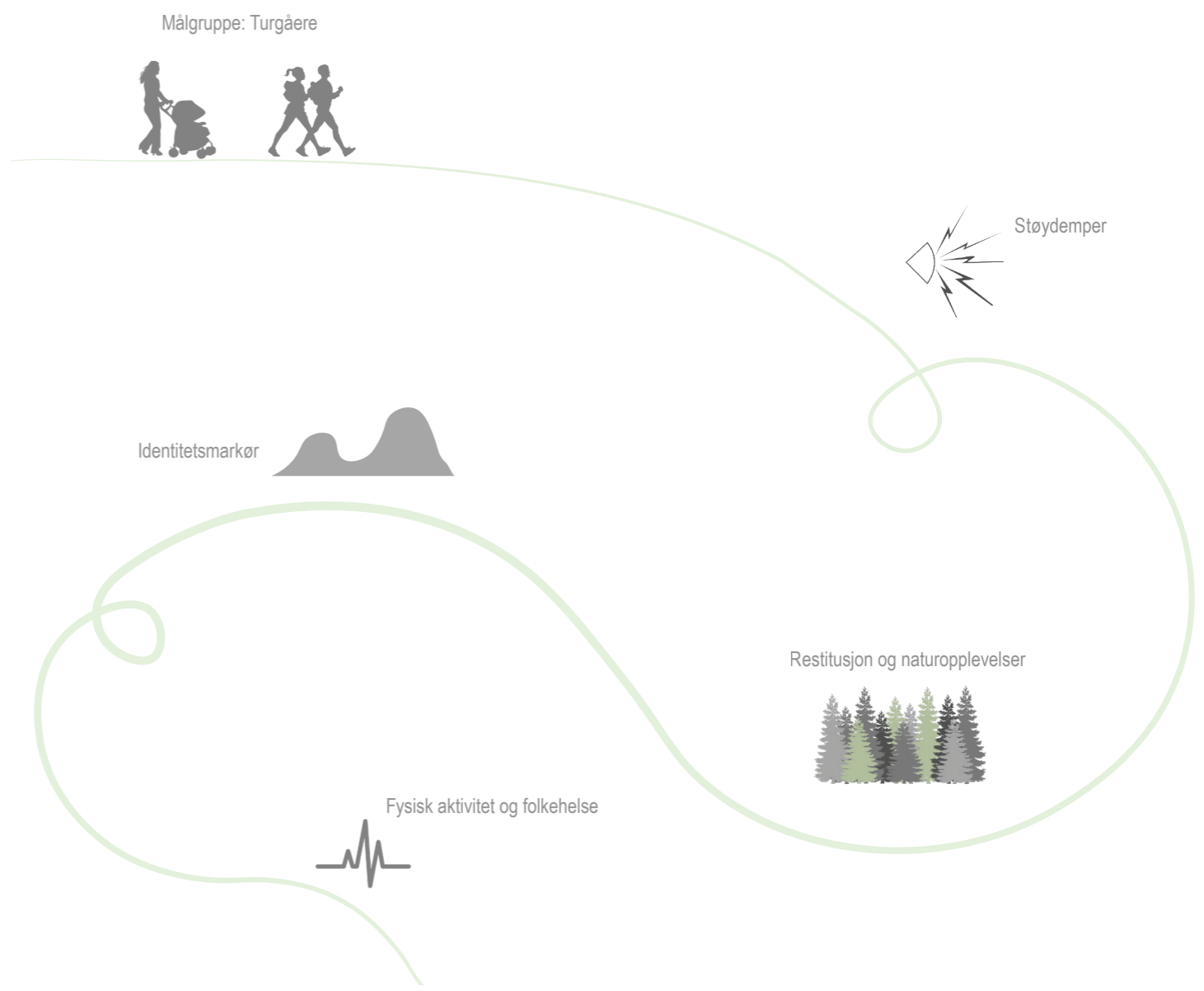

SKATEPARK - PLAN



1m 5m 10m

SKATEPARK - SNITT

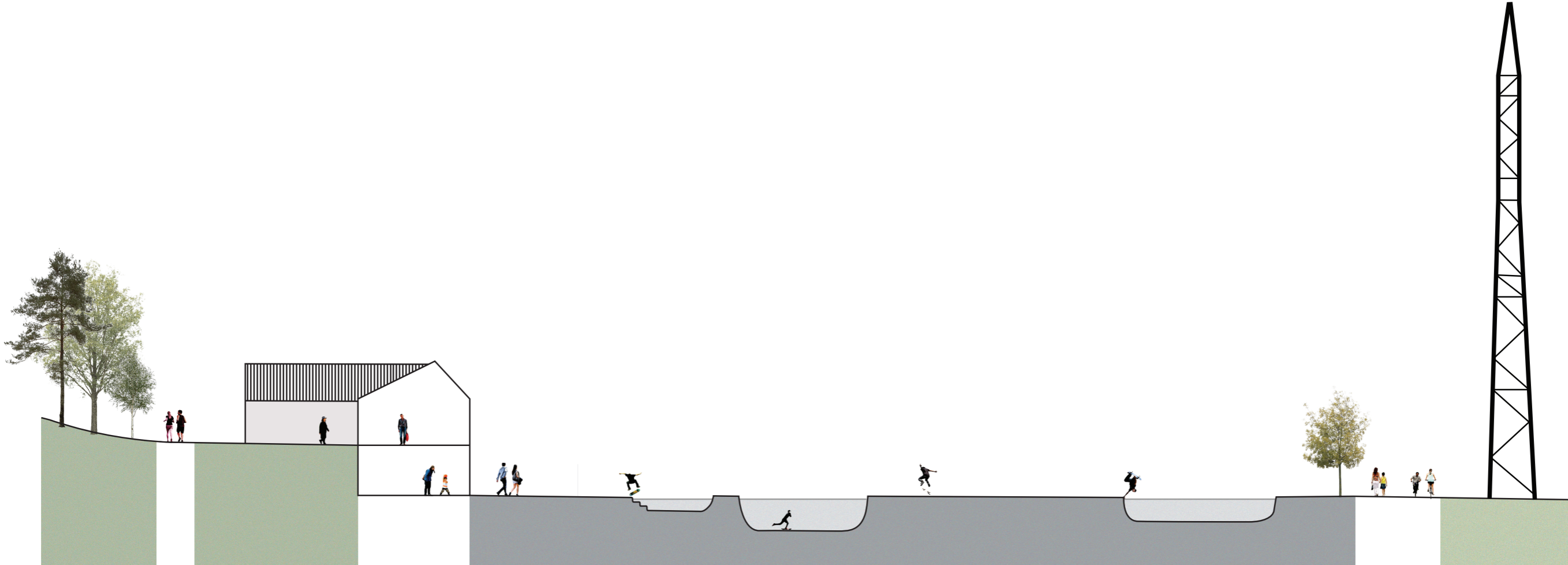

MASTEKONSTRUKSJONER - SNITT

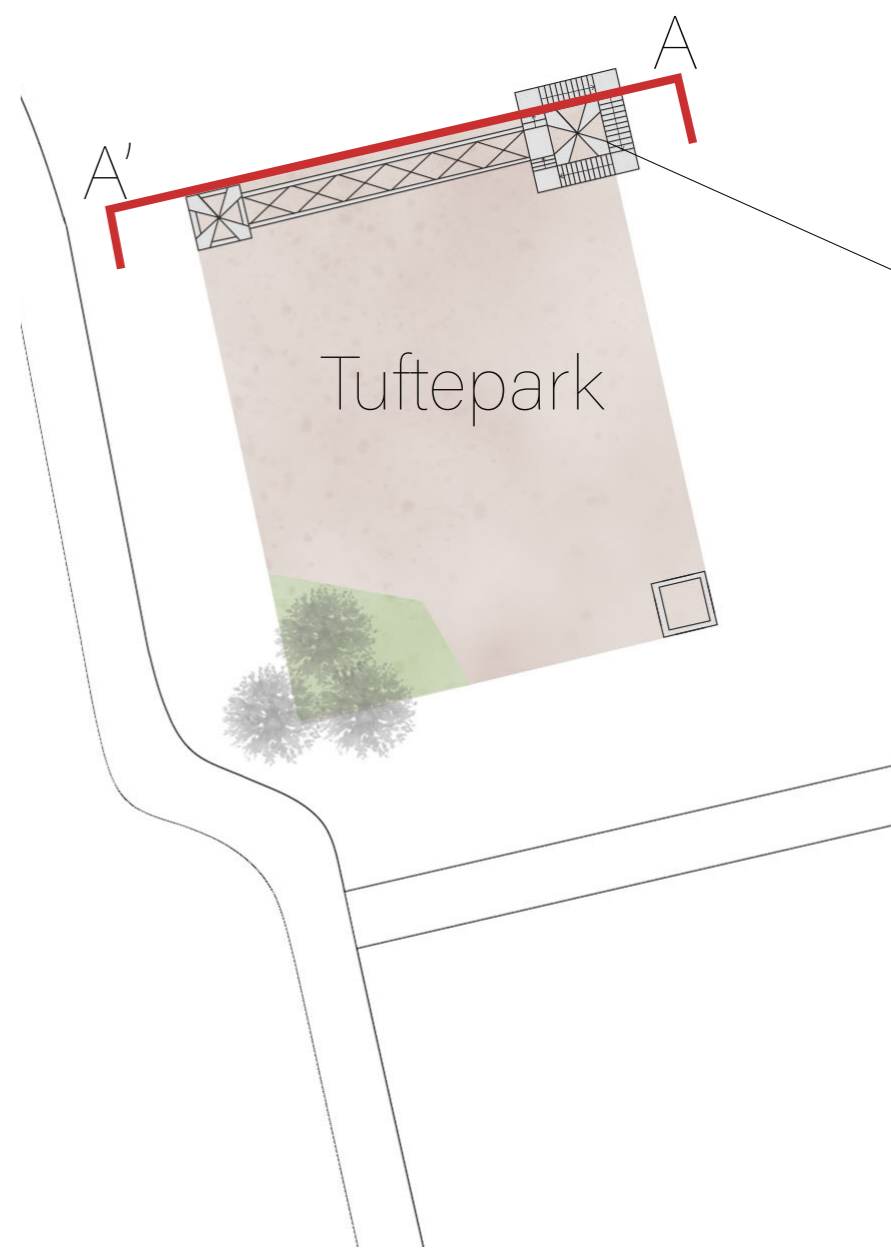
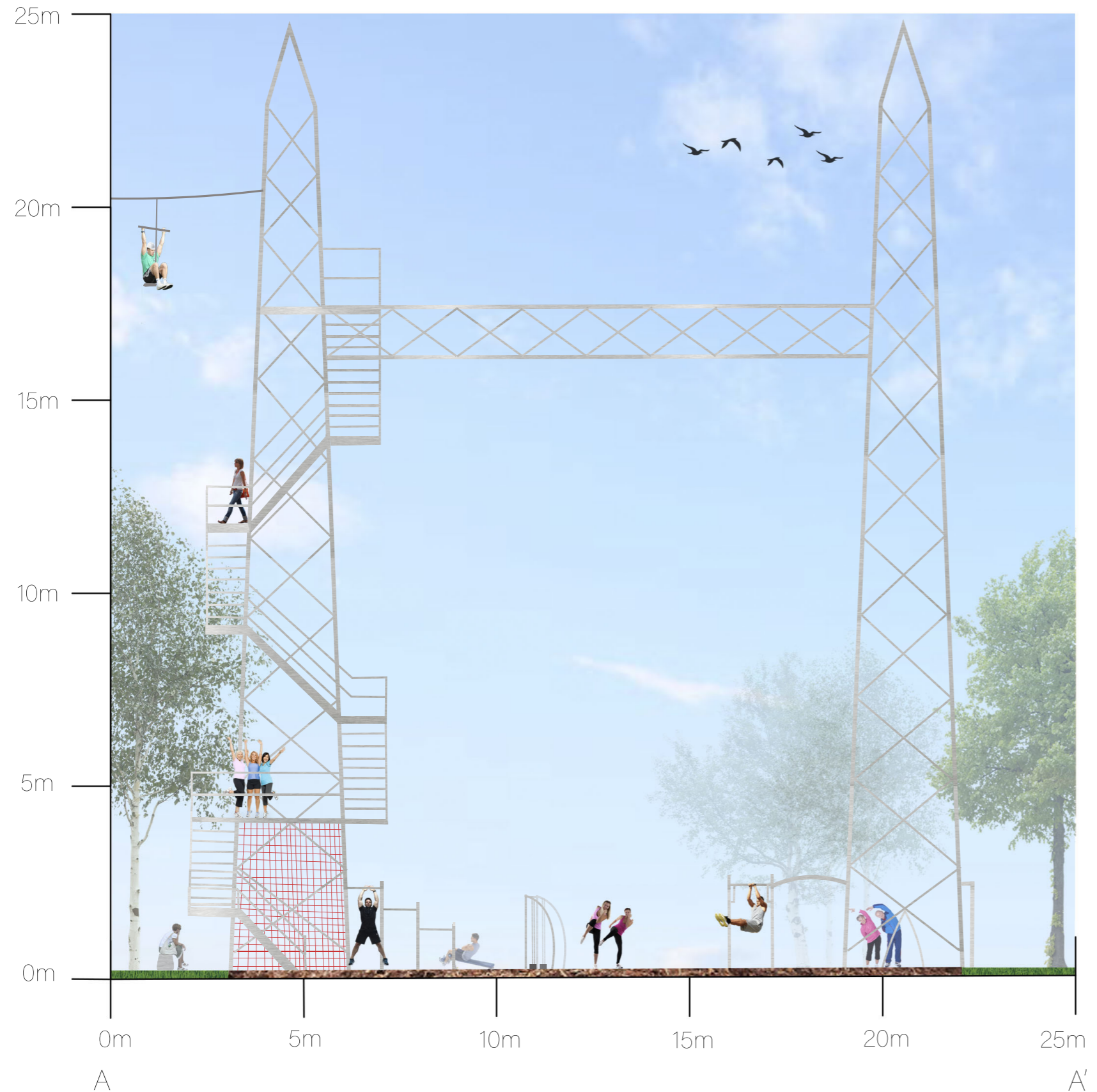

M: 1:150

MASTEKONSTRUKSJONER - SNITT

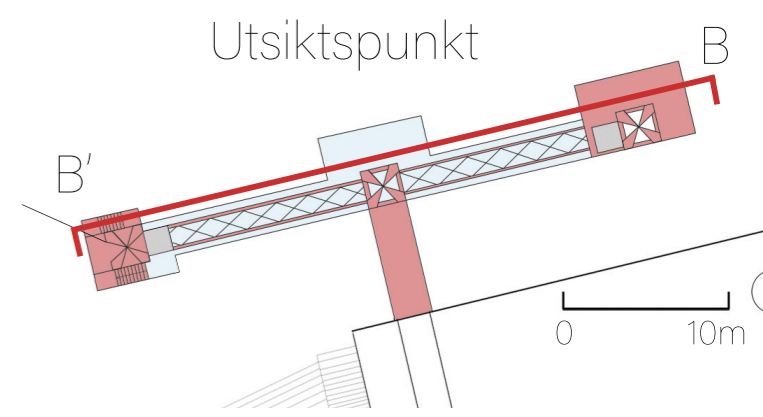
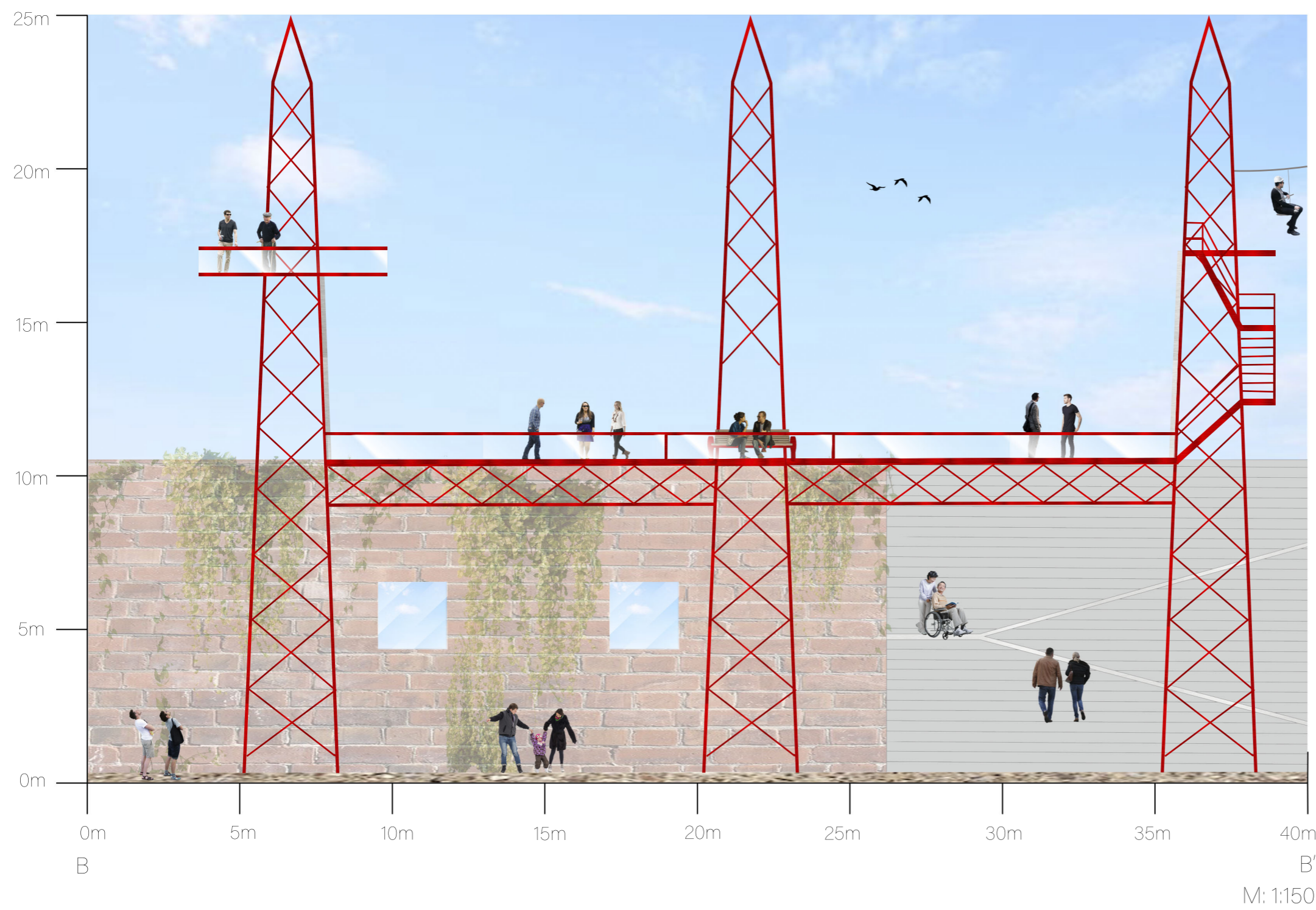

MUSIKK- OG INSTALLASJONSROM

- SAMHANDLING

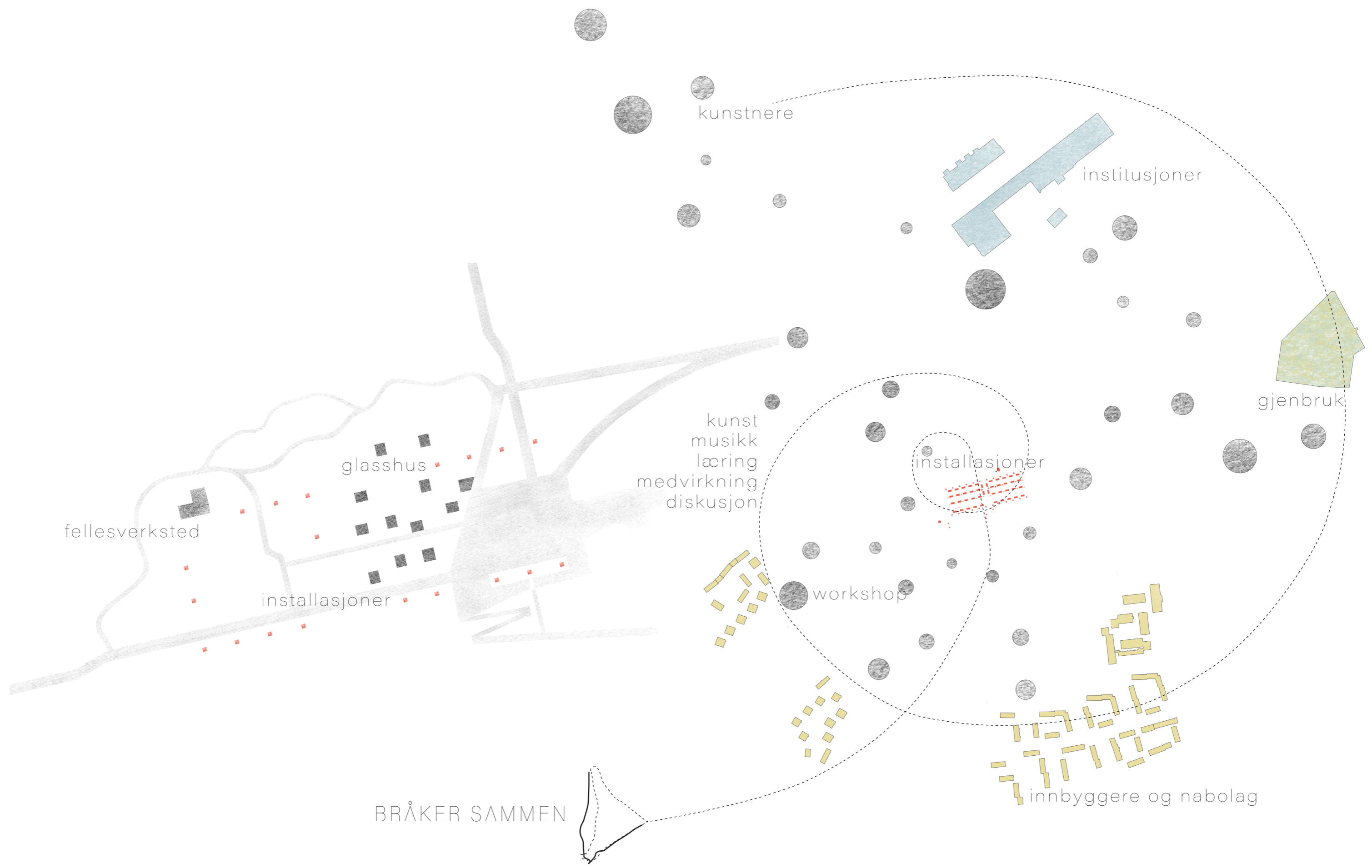

BRÅKER SAMMEN

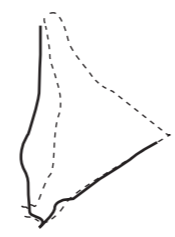

MUSIKK- OG INSTALLASJONSROM

- ÅPEN OG LUKKET FORM

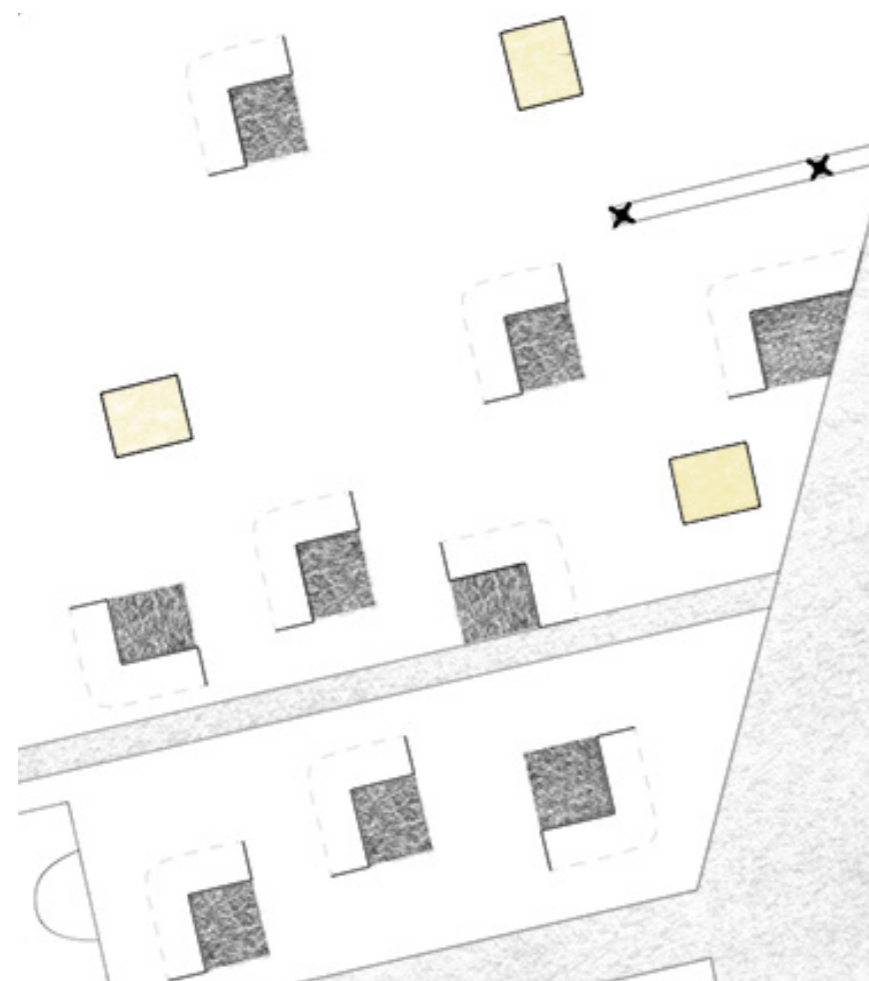
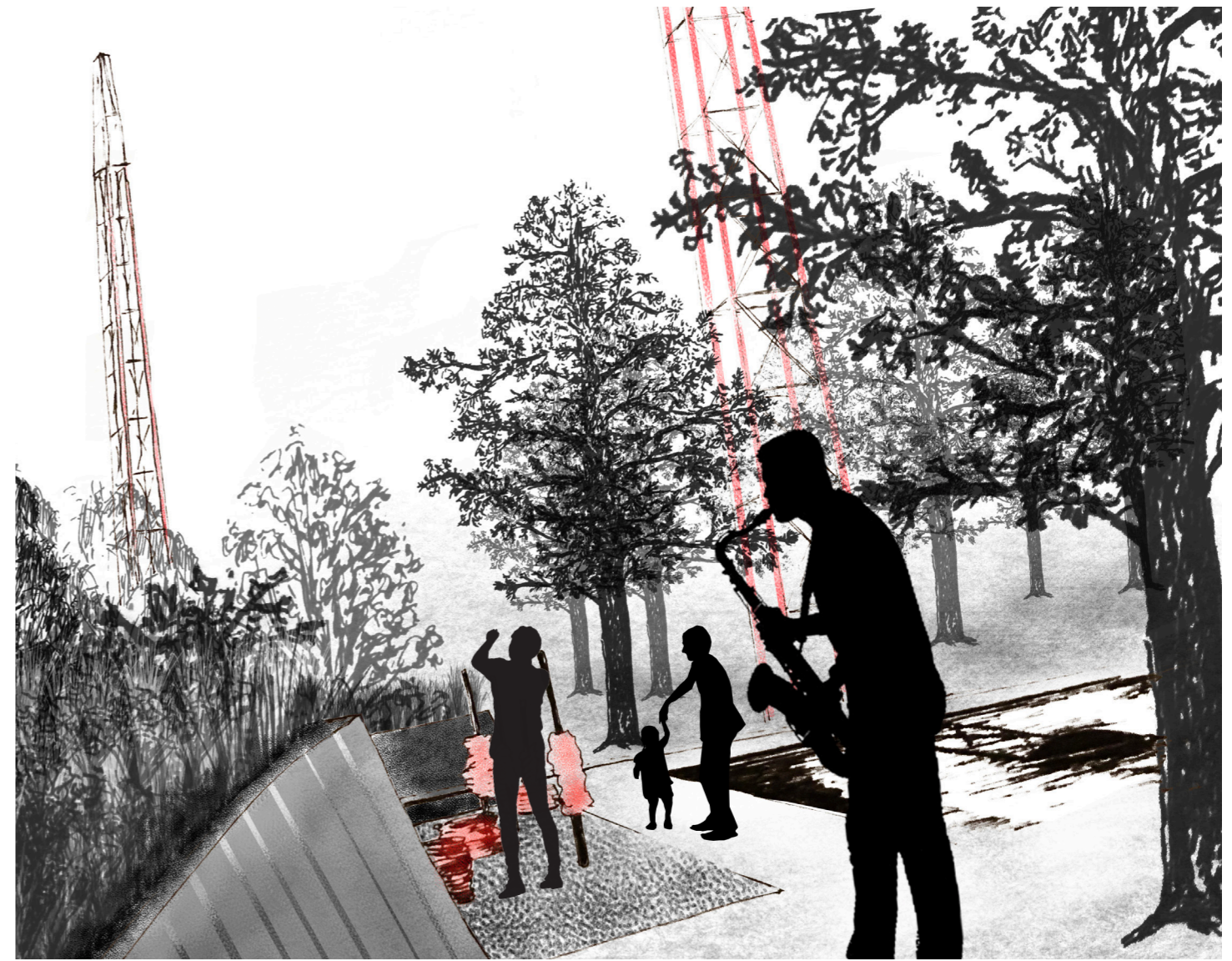
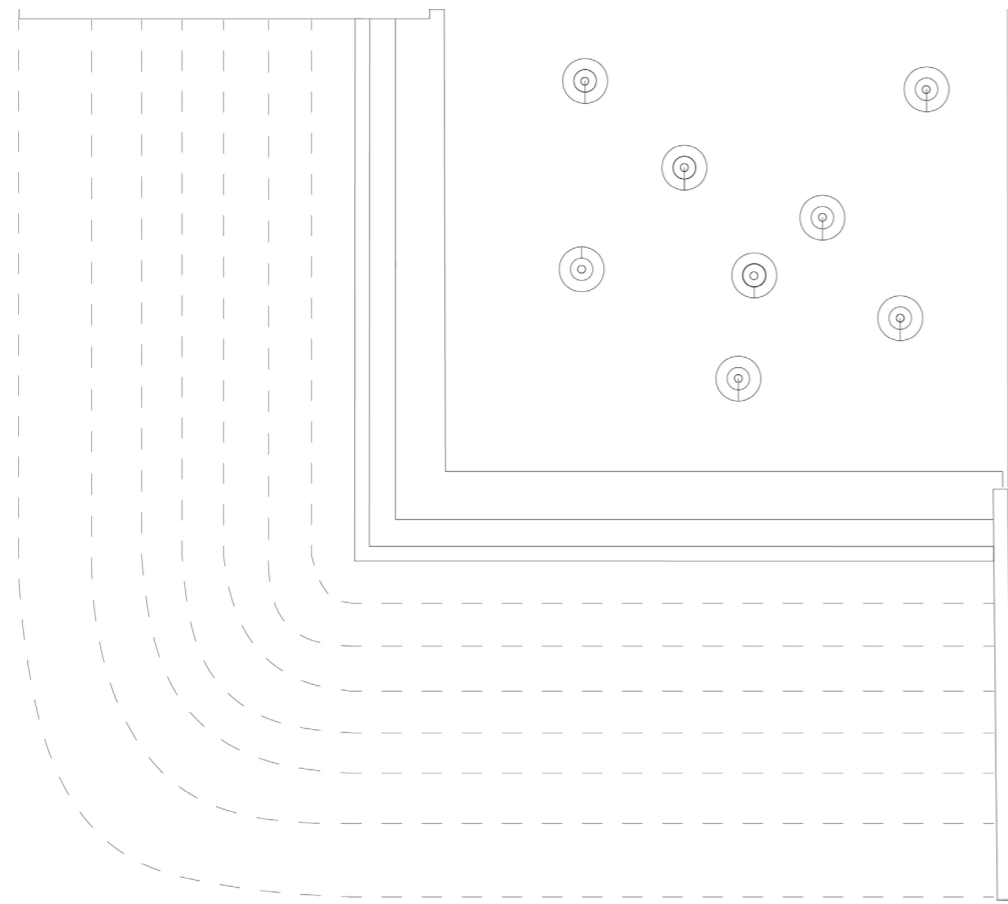

TAKK FOR OSS!

